

THESE DRAWINGS AND SPECIFICATIONS ARE THE PROPERTY OF JBL INCORPORATED. THEY ARE ISSUED IN STRICT CONFIDENCE AND SHALL NOT BE REPRODUCED OR USED AS THE BASIS FOR MANUFACTURE OR APPARATUS WITHOUT WRITTEN PERMISSION.

REVISIONS			
LTR	DESCRIPTION	DRAFT	DATE
A	RELEASE TO MARKETING	TH	3/30/17

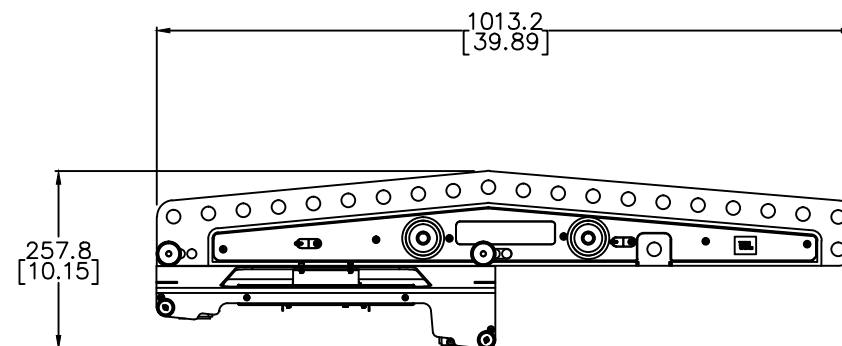
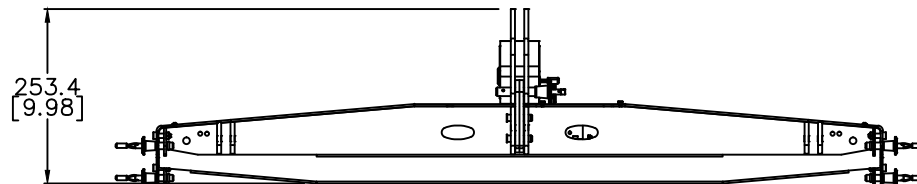
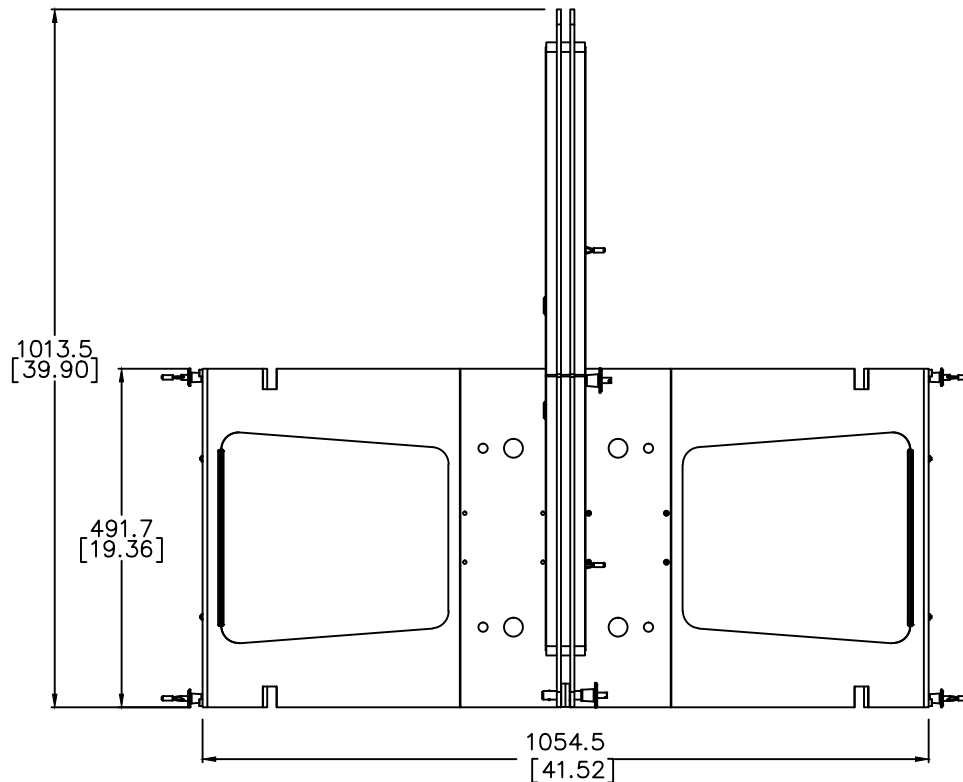

5. SHOWN WITH EXTENSION BAR EXTENDED TO THE REAR, THE EXTENSION BAR CAN EXTEND TO THE FRONT AND THE REAR OF THE FRAME TO ACCOMMODATE BOTH TILT UP OR TILT DOWN OPTIONS.

4. MATERIALS: HIGH GRADE STEEL WITH ANTI-CORROSION COATING.

3. WEIGHT: 41 kg (90 lbs)

2. FINISH: BLACK POWDERCOAT.

1. DIMENSIONS ARE mm[inches].

NOTES: (UNLESS OTHERWISE SPECIFIED)

TOLERANCES
(UNLESS OTHERWISE SPECIFIED)
X.XX ± .063 INCH
X.X ± .125 INCH
ANGULAR TOLERANCE OF 0°±30'
FRACTIONAL DIMENSIONS ± 1/32
* DIMENSIONS ARE MM [INCHES]
* ALL DIMENSIONS ARE FINISHED DIMENSIONS
* DO NOT SCALE DRAWING

JBL JBL PROFESSIONAL
A Harman International Company
Northridge, California 91329 U.S.A.

TITLE		
CUSTOMER DRAWING, VTX-A12-AF		
SIZE	DRAWING NO.	REV
A	1000303298	A
SCALE	SHEET	OF
NTS	1	1